

# ***USER MANUAL***

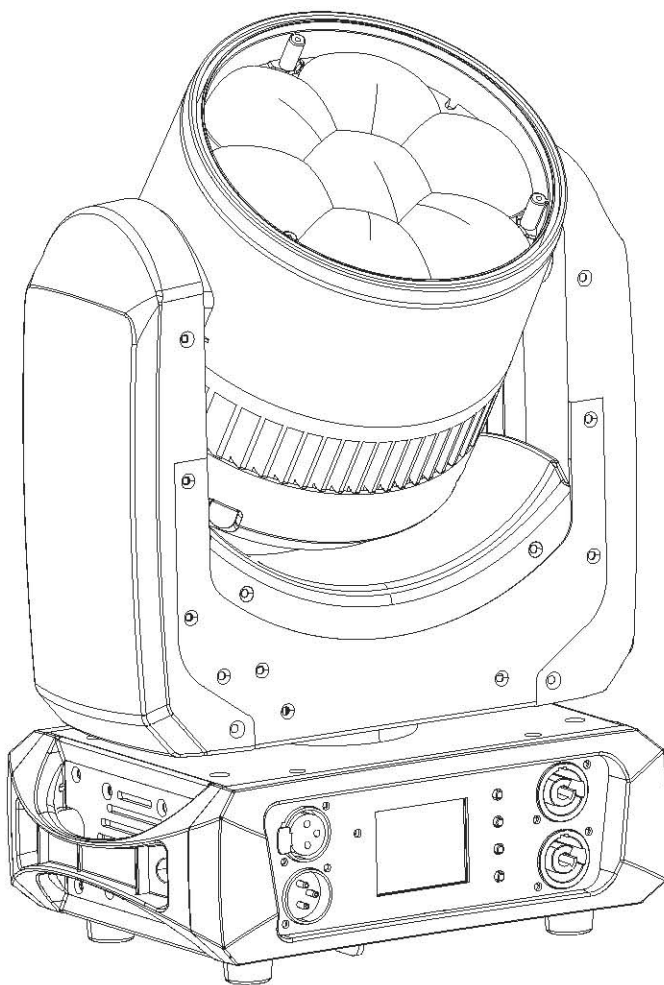

Version:1.0

# **NOVALIGHT**



## Table of content

<b>1.Open–Package guidelines.....</b>	<b>1</b>
<b>1. 1 Package.....</b>	<b>1</b>
<b>2.Safety instructions.....</b>	<b>1</b>
<b>3.Operating determination.....</b>	<b>3</b>
<b>4.Rigging the fixture.....</b>	<b>4</b>
<b>4.1 Mounting.....</b>	<b>4</b>
<b>4.2Installing the Clamps.....</b>	<b>4</b>
<b>4.3 Power supply connection and cut off.....</b>	<b>5</b>
<b>4.4 Power Connection.....</b>	<b>6</b>
<b>4.5 DMX–512 connection/connection between fixtures.....</b>	<b>6</b>
<b>5.Description of the device.....</b>	<b>7</b>
<b>6.Dimension.....</b>	<b>8</b>
<b>7.Display control.....</b>	<b>9</b>
<b>7.1 Navigation in the Menu.....</b>	<b>9</b>
<b>7.2 Display Operation.....</b>	<b>9</b>
<b>7.3 Menu list.....</b>	<b>10</b>
<b>8.DMX protocol.....</b>	<b>12</b>
<b>8.1 Unit model.....</b>	<b>12</b>
<b>9.Maintance and cleaning.....</b>	<b>16</b>
<b>10.Electric equipment specification.....</b>	<b>16</b>
<b>10.1 Electrical paramters.....</b>	<b>16</b>
<b>10.2 Weight and dimensions.....</b>	<b>16</b>
<b>10.3 Channel Characteristics.....</b>	<b>16</b>
<b>10.4 Menu Function.....</b>	<b>17</b>
<b>10.5 light table.....</b>	<b>17</b>
<b>11.Electronic drawing.....</b>	<b>18</b>

Congratulations on choosing our products! Please carefully read this instruction manual in its entirety and keep it well for using reference. This manual contained about the installation and the relative using information of this products. Please refer to this manual's relative instruction when using this equipment.

## 1.Open-Package guidelines

This equipment is made of new style,high intensity plastic.It fully shows the modem times light charac teristic with teristic with beauty struture. And it is made accord to CE standard. Fully agree with the internation standard of DMX512 agreement.

When receive the product,please be careful to take and put,check if the product has damage or not because of transportation, and check the following parts:

- |                    |                    |
|--------------------|--------------------|
| 1.Signal cable-1PC | 2.Safaty cable-1PC |
| 3.User Manval-1PC  | 4.Omega holder-1PC |
| 5.Power cable-1PC  | 5.Service card-1PC |

### 1.1 Package

Unpacking the fixture

- 1.Open the flight case cover
- 2.With one person on each side, lift the fixture out of the flight case.

Packing the fixture

- 1.Disconnect the fixture from power and allow it to cool.
- 2.Place the fix ture in the bottom of the flight case, and cover the case without forcing.



Note: to prevent the lamp damaged, focusing lens must return, can be placed in the box.

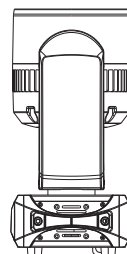

## 2.Safety instructions

Every person involvd with installation and maintenance of this device to:

- Be qualified
- Follow the instructions of this manual.



This device has been shipped with our premises in absolutely perfect condition. In order to maintain this condition and to ensure a safe operation, it is absolutely necessary for the user to follow the safety instructions and warning notes written in this manual.





### Important:

- The manufacturer will not accept liability for any resulting damages caused by the nonobservance of this manual or any unauthorized modification to the device.
- Please consider that damages caused by manual modifications to the device are not subject to warranty.

- Never let the power-cord come into contact with other cables! Handle the power cord and all connections with particular caution!
- Make sure that the available voltage is not higher than stated on the rearpanel.
- Always plug in the power plug least. Make sure that the power-switch is set to off-position before you connect with themains with particular caution!
- Make sure that the power-cord is never crimped or damaged by sharp edges. Check the device and the power-cord from time to time.
- Always disconnect from the mains, when the device is not in use or before cleaning it.
- Only handle the power-cord by the plug, Never pull out the plug by tugging the powercord.
- This device falls under protection class I. Therefore it is essential to connect the yellow/green conductor to earth.
- The electric connection, repairs and servicing must be carried out by a qualified employee.
- Do not connect this device to a dimmer pack.
- Do not switch the fixture on and off in short intervals as this would reduce the lamp's life.
- Do not touch the device's housing bare hands during its operation (housing becomes hot)!
- For replacement use lamps and fuses of same type and rating only.

### Eye damage!

**Avoid looking directly into the light source (meant especially for epileptics)!**

- |                                                                                     |                                                                                                                                                                                                                                                                                                                                                                                                                                                                                                                                                   |
|-------------------------------------------------------------------------------------|---------------------------------------------------------------------------------------------------------------------------------------------------------------------------------------------------------------------------------------------------------------------------------------------------------------------------------------------------------------------------------------------------------------------------------------------------------------------------------------------------------------------------------------------------|
|    | <ul style="list-style-type: none"> <li>➤ Minimum distance of illuminated objects<br/>The projector needs to be positioned so that the objects hit by the beam of light are at least 0.20 metres from the lens of the projector.</li> </ul>                                                                                                                                                                                                                                                                                                        |
| <p>t<sub>a</sub> 40°C</p>                                                           | <ul style="list-style-type: none"> <li>➤ Maximum ambient temperature<br/>Do not operate the fixture if the ambient temperature (T<sub>a</sub>) exceeds 40°C (104°F).</li> </ul>                                                                                                                                                                                                                                                                                                                                                                   |
| <p>t<sub>c</sub> 90°C</p>                                                           | <ul style="list-style-type: none"> <li>➤ Temperature of the external surface<br/>The maximum temperature that can be reached on the external surface of the fitting, in a thermally steady state, is 90°C (194°F).</li> </ul>                                                                                                                                                                                                                                                                                                                     |
| <p>IP20</p>                                                                         | <ul style="list-style-type: none"> <li>➤ IP20 protection rating<br/>The fitting is protected against penetration by solid of over 12mm (0.47") in diameter (first digit 2), but not against dripping water, rain, splashes or jets of water (second digit 0).</li> </ul>                                                                                                                                                                                                                                                                          |
|    | <ul style="list-style-type: none"> <li>➤ Indoor use only</li> </ul>                                                                                                                                                                                                                                                                                                                                                                                                                                                                               |
|   | <ul style="list-style-type: none"> <li>➤ Not suitable for household illumination</li> </ul>                                                                                                                                                                                                                                                                                                                                                                                                                                                       |
|  | <ul style="list-style-type: none"> <li>➤ Photobiological Safety<br/>CAUTION. Possibly hazardous optical radiation emitted from this product. Do not stare at operating lamp. May be harmful to the eyes.</li> </ul>                                                                                                                                                                                                                                                                                                                               |
|  | <ul style="list-style-type: none"> <li>➤ Light collimation system<br/>This product contains internal light collimation system. Avoid intense light from any angle.</li> </ul>                                                                                                                                                                                                                                                                                                                                                                     |
| <p>CE</p>                                                                           | <ul style="list-style-type: none"> <li>➤ The products to which this manual refers comply with the European Directives pursuant to: <ul style="list-style-type: none"> <li>• Safety of electrical equipment supplied at low voltage (LVD)<br/>EN 60598-1:2015<br/>EN 60598-2-17:1989+A2:1991</li> <li>• Electromagnetic Compatibility (EMC)<br/>EN 55015:2013/A1:2015<br/>EN 61000-3-2:2014<br/>EN 61000-3-3:2013<br/>EN 61547:2019</li> <li>• Restriction of the use of certain hazardous substances (RoHS)<br/>2011/65/EU</li> </ul> </li> </ul> |



➤ Protection against electrical shock

Connection must be made to a power supply system fitted with efficient earthing (Class I appliance according to standard EN 60598-1). It is, moreover, recommended to protect the supply lines of projectors from indirect contact and/or shorting to earth by using appropriately sized residual current devices.



➤ Disposing

This product is supplied in compliance with European Directive 2012/19/EU-Waste Electrical and Electronic Equipment (WEEE). To preserve the environment please dispose/recycle this product at the end of its life according to the local regulation.



➤ Battery

This product contains a rechargeable lead-acid or lithium iron tetraphosphate battery. To preserve the environment, please dispose the battery at the end of its life according to the regulation in force.



➤ Lamp

The fitting mounts a high-pressure lamp that needs an external igniter. This igniter is fitted onto the apparatus. -Carefully read the "operating instructions" provided by the lamp manufacturer. -Immediately replace the lamp if damaged or deformed by heat.



➤ Maintenance

Before starting any maintenance work or cleaning the projector, cut off power from the mains supply. After switching off, do not remove any parts of the fitting for at least 20 minutes. After this time the likelihood of the lamp exploding is virtually small. If it is necessary to replace the lamp, wait for another 20 minutes to avoid getting burnt. The fitting is designed to hold in any splinters produced by a lamp exploding.



### 3. Operating determinations

- This device is a moving-head for creating decorative effects and was designed for indoor use only.
- If the device has been exposed to drastic temperature fluctuation (e.g. after transportation), do not switch it on immediately. The arising condensation water might damage your device. Leave the device switched off until it has reached room temperature.
- Never run the device without lamp!
- Do not shake the device. Avoid brute force when installing or operating the device.
- Never lift the fixture by holding it at the projector head, as the mechanics may be damaged. Always hold the fixture at the transport handles.
- When choosing the installation spot, please make sure that the device is not exposed to heat, moisture or dust. There should not be any cables lying around. You endanger your own and the safety of others!
- The minimum distance between light output and the illuminated surface must be more than 0.2 meters.
- Make sure that the area below the installation place is blocked when rigging, derigging or servicing the fixture.
- Always fix the fixture with an appropriate safety rope. Fix the safety rope at the correct holes only.
- Operate the fixture after having checked that the housing is firmly closed and all screws are tightly fastened.
- The lamp must never be ignited if the objective-lens or any housing-cover is open, as discharge lamps may explode and emit a high ultraviolet radiat, which may cause burns.
- The maximum ambient temperature 40° C must never be exceeded.
- Operate the device only after having familiarized with its functions. Do not permit operation by persons not qualified for operating the device. Most damages are the result of unprofessional operation!
- Please use the original packaging if the device is to be transported.
- Please consider that unauthorized modifications on the device are forbidden due to safety reasons!
- If this device will be operated in any way different to the one described in this manual, the product may suffer damages and the guarantee becomes void. Furthermore, any other operation may lead to dangers like short-circuit, burns, electric shock, burns due to ultraviolet radiation, lamp explosion, crash etc.

---

## 4. Rigging the fixture

### 4.1 Mounting



*Pay attention to the regulations of CE.*

*Installation by qualified staff to complete.*

- ☞ For the various mounting positions of the FIXTURE (standing on the floor, sideways or hanging different accessories kits are available).
- ☞ Through this a safe and firm installation is assured.
- ☞ You'll find special connectors on the bottom side of the system which are put to use here.

### 4.2 Installing the Clamps

Please consider the respective national norms during the installation! The installation must only be carried out by an authorized dealer!

The installation of the projector has to be built and constructed in a way that it can hold 10 times the weight for 1 hour without any harming deformation.

The installation must always be secured with a secondary safety attachment, e.g. an appropriate catch net. This secondary safety attachment must be constructed in a way that no part of the installation can fall if the main attachment fails.

When servicing the fixture staying in the area below the installation place, on bridges, under high working places and other endangered areas is forbidden.

The operator has to make sure that safety-relating and machine-technical installations are approved by an expert before taking into operation for the first time and after changes before taking into operation another time.

The operator has to make sure that safety-relating and machine-technical installations are approved by an expert after every four years in the course of an acceptance test.

The operator has to make sure that safety-relating and machine-technical installations are approved by a skilled person once a year.

The projector should be installed outside areas where persons may walk by or be seated.

**Important!** Overhead rigging requires extensive experience CE, including (but not limited to) calculating working load limits, installation material being used, and periodic safety inspection of all installation material and the projector. If you lack these qualifications, do not attempt the installation yourself, but instead use a professional structural rigger. Improper installation can result in bodily injury and or damage to property.

The projector has to be installed out of the reach of people.

If the projector shall be lowered from the ceiling or high joists, professional trussing systems have to be used. The projector must never be fixed swinging freely in the room.

**Caution** Projectors may cause severe injuries when crashing down! If you have doubts concerning the safety of a possible installation, do not install the projector!

Before rigging make sure that the installation area can hold a minimum point load of 10 times the projector's weight.



The projector can be placed directly on the stage floor or rigged in any orientation on a truss without altering its operation characteristics.

For overhead use, always install a safety-rope that can hold at least 10 times the weight of the fixture. You must only use safety-ropes with screw on carabines. Pull the safety-rope through the two apertures on the bottom of the base and over the trussing system etc.

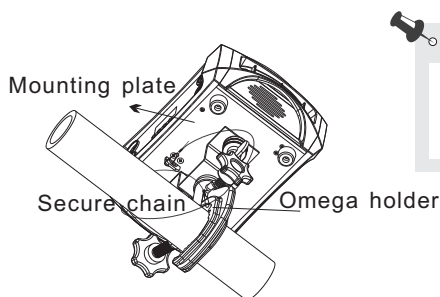

**Warning:** it is necessary to make sure that the installation location is perfectly appropriate, and the installation location is safe and reliable.

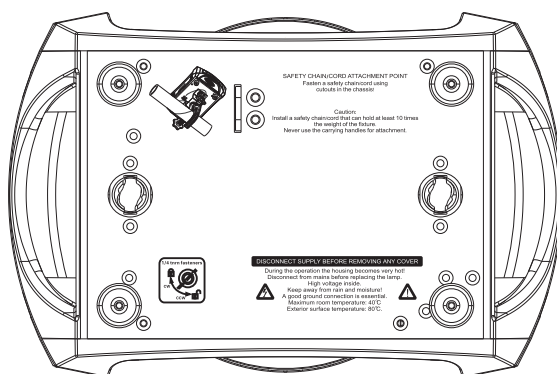

### 4.3 Power supply connection and cut off

Connect the light source to the main power source with the plug of the power cord, or cut off the power supply:

**Connection:** according to procedures, the power plug and socket is inserted into the groove one one alignment, rotation.

**Cut off:** according to procedures, press the button on the rotating plug, pull out.

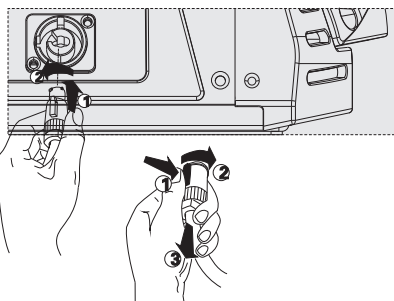

### 4.4 Power Connection

If you wish to change the power supply settings, see the chapter appendix Connect the fixture to the mains with the enclosed power cable and plug.



**Warning:** please verify the power of the power supply equipment prior to the connection! Earth wire must be grounded!

CABLE(EU)	CABLE(US)	Pin	INTERNATIONAL
Brown	Black	Live	<b>L</b>
Light blue	White	Neutral	<b>N</b>
Yellow/Green	Green	Earth	<b>⊕</b>

### 4.5 DMX-512 connection/connection between fixtures

Only use stereo shielded cable and 3-pin XLR-plugs and connectors in order to connect.

Standard edition

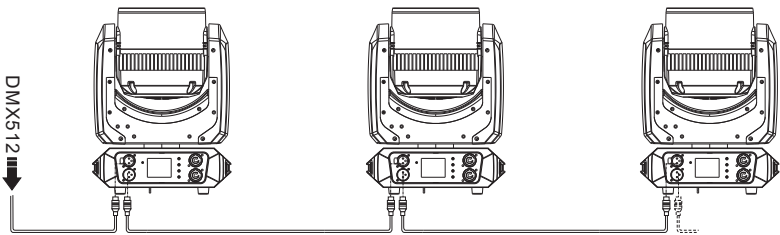

#### Caution

At the last fixture, the DMX-cable has to be terminated with a terminator. solder a 120 resistor between signal(-) and Signal (+) into a 3-pin XLR-plug and plug it in the DMX-output of the last fixture.

DMX output  
3-pin XLR socket



DMX input  
3-pin XLR socket



1: Ground  
2: Signal (-)  
3: Signal (+)

DMX output  
5-pin XLR socket



DMX input  
5-pin XLR socket



1: Ground  
2: Signal (-)  
3: Signal (+)  
4: N. A.  
5: N. A.

### DMX Terminator Diagram

-For installations where the DMX cable has to run a long distance or is in an electrically noisy environment it is recommended to use a DMX terminator. This helps in preventing corruption of the signal by electrical noise. The DMX terminator is simply an XLR plug with a  $120\Omega$  resistor connected between pins 2 and pins 3, which is then plugged into the output XLR socket of the last fixture in the chain.

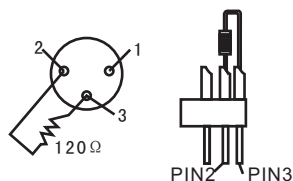

## 5. Description of the device

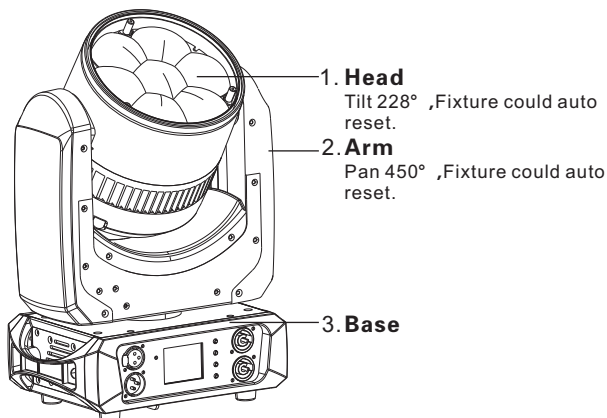

### European standard edition

4. 5-pin XLR female

5. 5-pin XLR male

6. display

7. power in

8. power out

9. MODE button

10. UP button

11. DOWN button

12. ENTER button

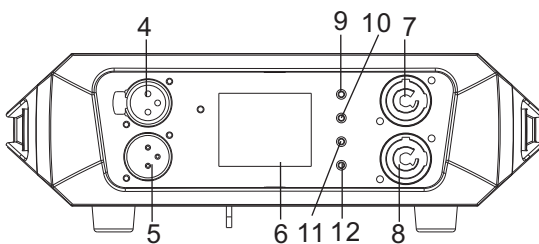

## 6.Dimension

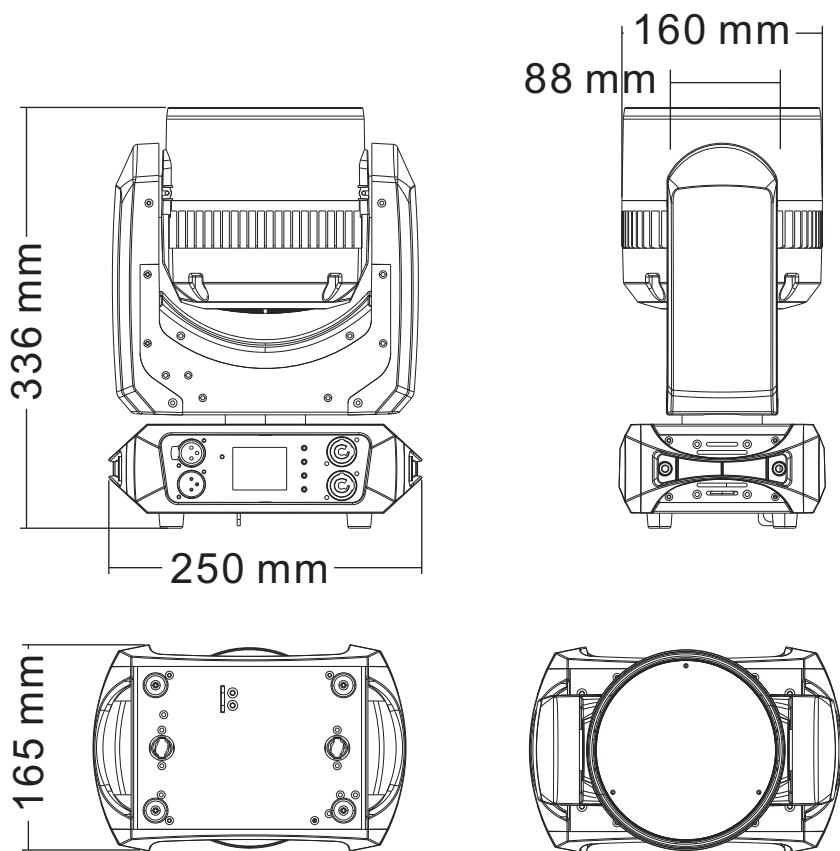

---

## 7.Display control

### 7.1 Navigation in the Menu

Using the buttons or touch screen, and this can be simply and easily set the address code and functions code.

If you view or modify the lighting feature set, then press ENTER button, the display will enter the menu interface. Both there is sub menu corresponding to the functional operation of the main menu. Each of the menus is representative of the specific features of the lamp. The specific contents shows as the table menu below.

Set or browse lighting function, press UP or DOWN button.

Press ENTER to save your changes or enter the submenu. Press the UP or DOWN can change the numerical (increase or decrease in value).

Press the MODE button to return to menu. Set a time 0 to 10 minutes automatically exit menu interface and close the screen.

### 7.2 Display Operation

Put through power supply, open the power switch of lamps and lanterns, display show the company LOGO website. According to the main interface, as shown in figure:

In the main interface, press "MODE" button to view the software version, press the "UP" "DOWN" can modify the DMX address.

Click on the main interface of the icon, numerical to view view Settings related information of lamps and lanterns. Symbols such as the main interface appear "△", the following error message indicates that there might be a lamps and lanterns, can click to view and control information content to modify the lamps and lanterns.

CODE #	ERRO INFO	CHECK MEASURMENT	NOTE
	BD1 Err	Check main cable ABAB ( 485 ) chip	
	BD2 Err		
	Pan FB. Err	Check the light coupling line, optical coupling switch and a plate of the relative position measurement	
	Tilt FB. Err		
	Pan Zero Err	Check cable of sensor, distance and location of ,magnets and sensor	
	Tilt Zero Err		

### 7.3 Menu list

Address	DMX Address	001-XXX		
	Channel Mode	Standard * 1-22		Default: Standard
		Easy 1-16		
		Jolly 1-22		
	Fixture Id	Close/001-999		
	ON DMX	Close		Default: Hold
		Hold *		
		Static		
		Program 1		
		Program 2		
Information	Fixture Times	Resettable xxxxH xxM	Clear	
		Total xxxxH xxM		
	Error List			
	DMX Values			
	DMX Diagnosis			
	System Information			
Personality	Pan Invert	ON/OFF *		Default: OFF
	Tilt Invert	ON/OFF *		Default: OFF
	Feedback	ON */OFF		Default: ON
	Dim.Curve	Liner *		Default:Liner
		S Curve		
		Inv SQ		
		Square		
	Screen Time	OFF		Default:2 Min.
		1 Min.		
		2 Min. *		
		5 Min.		
	Auto Screen	10 Min.		Default:OFF
		ON/OFF		
		Auto *		
		High		
	Fan Mode	Silence		Default:Auto
		Auto *		
		DMX		
		Static		
	Boot Mode	Program 1		Default:Auto
		Program 2		
		Program 3		
		English		
	Language	中文		

Stand-Alone	Test Sequence	Run/Stop		
	M/S	Master		Default:Slave
		Slave		
	Static Mode	Pan	0-255	
		Tilt	0-255	
		ZOOM	0-255	
		Colour	0-255	
		R	0-255	
		G	0-255	
		B	0-255	
		W	0-255	
		Strobe	0-255	
		Dimmer	0-255	
	Program Edit	Program 1/2/3		
		Step	01-30	
		Reset	Reset Step	
			Reset Def.	
		Fade Time	0-999	
		Hold Time	0-999	
		Pan	0-255	
		Tilt	0-255	
		ZOOM	0-255	
		Colour	0-255	
		R	0-255	
		G	0-255	
		B	0-255	
		W	0-255	
		Dimmer	0-255	
		Strobe	0-255	
	Program Play	Program 1		
		Program 2		
		Program 3		
Service	Reset	Pan/Tilt/Zoom		
	Calibrations	Input Password:****	Pan	
			Tilt	
			Zoom	
	Factory Default			

## 8.DMX protocol

### 8.1 Unit model

Mode1	Mode2	Mode3	Dmx Value	Function	Fade Type
1	1	1	Pan	Pan movement by 450°	0-255
2	2	2	Pan Fine	Fine control of pan movement	0-255
3	3	3	Tilt	Tilt movement by 228°	0-255
4	4	4	Tilt fine	Fine control of tilt movement	0-255
5	5	5	Pan/Tilt Speed Pan/Tilt Time	Standard mode	0
				Max. Speed Mode	1
				Pan/Tilt speed mode	
				Speed from max. to min	2-255
				Pan/Tilt time mode	
6	6	6	Power/Special Functions	Time from 0.2 sec. to 25.5 sec	2-255
				Reserved	0-19
				To activate following functions, stop in DMX value for at least 3 s and shutter must be closed at least 3 sec.(Shutter,Strobe) channel 20/15 must be at range: 0-31 DMX). Corresponding menu items are temporarily overridden	
				Display ON	20-24
				Display OFF	25-29
				RGBW colour mixing mode	30-34
				CMY colour mixing mode	35-39
				Pan/Tilt speed mode	40-44
				Pan/Tilt time mode	45-49
				Blackout while pan/tilt moving	50-54
				Disabled blackout while pan/tilt moving	55-59
				Dimmer curve – square law	60-64
				Dimmer curve – linear	65-69
				Fans mode: Auto	70-74
				Fans mode: High	75-79
				White point 8000K ON	80-84
				White point 8000K OFF	85-89
				Fans mode: Quiet	90-94
				Reserved	95-129
				To activate following functions, stop in DMX value for at least 3 seconds.	
				Reserved	130-139
				Pan/Tilt reset	140-149
				Zoom reset	150-159
				Reserved	160-169
				Tungsten effect simulation for whites 2700K and 3200K	
				Tungsten effect simulation (750W) On	170-171
				Tungsten effect simulation (1000W) On	172-173
				Tungsten effect simulation (1200W) On	174-175
				Tungsten effect simulation (2000W) On	176-177
				Tungsten effect simulation (2500W) On	178-179
				Tungsten effect simulation Off	180-181
				Reserved	182-255
7	7	7	Virtual colour wheel	No function (0=default)	0
				Filter 4 (Medium Bastard Amber)	1-2
				Filter 25 (Sunset Red)	3-4
				Filter 19 (Fire)	5-6



Mode1	Mode2	Mode3	Dmx Value	Function	Fade Type
7	7	7	Virtual colour wheel	Filter 26 (Bright Red)	7-8
				Filter 58 (Lavender)	9-10
				Filter 68 (Sky Blue)	11-12
				Filter 36 (Medium Pink)	13-14
				Filter 89 (Moss Green)	15-16
				Filter 88 (Lime Green)	17-18
				Filter 90 (Dark Yellow Green)	19-20
				Filter 49 (Medium Purple)	21-22
				Filter 52 (Light Lavender)	23-24
				Filter 102 (Light Amber)	25-26
				Filter 103 (Straw)	27-28
				Filter 140 (Summer Blue)	29-30
				Filter 124 (Dark Green)	31-32
				Filter 106 (Primary Red)	33-34
				Filter 111 (Dark Pink)	35-36
				Filter 115 (Peacock Blue)	37-38
				Filter 126 (Mauve)	39-40
				Filter 117 (Steel Blue)	41-42
				Filter 118 (Light Blue)	43-44
				Filter 122 (Fern Green)	45-46
				Filter 182 (Light Red)	47-48
				Filter 121 (Filter Green)	49-50
				Filter 128 (Bright Pink)	51-52
				Filter 131 (Marine Blue)	53-54
				Filter 132 (Medium Blue)	55-56
				Filter 134 (Golden Amber)	57-58
				Filter 135 (Deep Golden Amber)	59-60
				Filter 136 (Pale Lavender)	61-62
				Filter 137 (Special Lavender)	63-64
				Filter 138 (Pale Green)	65-66
				Filter 798 (Chrysalis Pink)	67-68
				Filter 141 (Bright Blue)	69-70
				Filter 147 (Apricot)	71-72
				Filter 148 (Bright Rose)	73-74
				Filter 152 (Pale Gold)	75-76
				Filter 154 (Pale Rose)	77-78
				Filter 157 (Pink)	79-80
				Filter 143 (Pale Navy Blue)	81-82
				Filter 162 (Bastard Amber)	83-84
				Filter 164 (Flame Red)	85-86
				Filter 165 (Daylight Blue)	87-88
				Filter 169 (Lilac Tint)	89-90
				Filter 170 (Deep Lavender)	91-92
				Filter 172 (Lagoon Blue)	93-94
				Filter 194 (Surprise Pink)	95-96
				Filter 180 (Dark Lavender)	97-98
				Filter 181 (Congo Blue)	99-100
				Filter 197 (Alice Blue)	101-102
				Filter 201 (Full C.T. Blue)	103-104
				Filter 202 (Half C.T. Blue)	105-106
				Filter 203 (Quarter C.T. Blue)	107-108

Mode1	Mode2	Mode3	Dmx Value	Function	Fade Type
7	7	7	Virtual colour wheel	Filter 204 (Full C.T. Orange)	109-110
				Filter 219 (Fluorescent Green)	111-112
				Filter 206 (Quarter C.T. Orange)	113-114
				Filter 247 (Filter Minus Green)	115-116
				Filter 248 (Half Minus Green)	117-118
				Filter 281 (Three Quarter C.T. Blue)	119-120
				Filter 285 (Three Quarter C.T. Orange)	121-122
				Filter 352 (Glacier Blue)	123-124
				Filter 353 (Lighter Blue)	125-126
				Filter 507 (Madge)	127-128
				Filter 778 (Millennium Gold)	129-130
				Filter 793 (Vanity Fair)	131-132
				Raw DMX	133-235
				Rainbow effect (with fade time) from slow-> fast	236-245
				Rainbow effect (without fade time) from slow-> fast	246-255
8	8	*	Red/Cyan	Colour saturation control – coarse 0-100%	0-255
9	*	*	Red/Cyan fine	Colour saturation control – fine	0-255
10	9	*	Green/Magenta	Colour saturation control – coarse 0-100%	0-255
11	*	*	Green/Magenta fine	Colour saturation control – fine	0-255
12	10	*	Blue/Yellow	Colour saturation control – coarse 0-100%	0-255
13	*	*	Blue/Yellow fine	Colour saturation control – fine	0-255
14	11	*	White	If RGBW mode is selected:	
				Colour saturation control – coarse 0-100%	0-255
				If CMY mode is selected:	
15	*	*	Whitefine	No function	0-255
				Colour saturation control – fine	0-255
*	*	8	Red – zones 1	Red 0-100%	0-255
*	*	9	Green – zones 1	Green 0-100%	0-255
*	*	10	Blue – zones 1	Blue 0-100%	0-255
*	*	11	White – zones 1	White 0-100%	0-255
*	*	12	Red – zones 2	Red 0-100%	0-255
*	*	13	Green – zones 2	Green 0-100%	0-255
*	*	14	Blue – zones 2	Blue 0-100%	0-255
*	*	15	White – zones 2	White 0-100%	0-255
*	*	16	Shape Selection	UNUSED RANGE	0-7
				Shape 1	8-17
				Shape 2	18-27
				Shape 3	28-37
				Shape 4	38-47
				Shape 5	48-57
				UNUSED RANGE	58-255
*	*	17	Shape Speed	Shape Speed Slow→Fast	0-255
*	*	18	Shape Fade	Shape Fade 0-100%	0-255
16	12	19	CTC	If function "White Point 8000K" is ON To get colour temperatures stated above, RGBW channels have to be set at the same value e.g. 255 DMX (0=default)	
				8000K	0
				5600K	64
				4200K	128
				3200K	192
				2700K	255

Mode1	Mode2	Mode3	Dmx Value	Function	Fade Type
16	12	19	CTC	To activate Tungsten effect at 2700K and 3200K , set DMX value at "Power/Special functions" channel) If function "White Point 8000K" is OFF	
				Colour temperature correction for from cool white to 2700K	0-255
17	13	*	Colour Mix control	Defines relation between colour channels "Virtual" = Virtual Colours (Virtual Colour Wheel) "Colour mix" = Colour channels (RGBW/CMY)	
				Virtual colors ("Virtual" has priority)	0-9
				Maximum mode (highest values have priority)	10-19
				Minimum mode (lowest values have priority)	20-29
				Multiply mode (multiply Virtual and Colour Mix)	30-39
				Addition mode (Virtual + Colour mix) (45=default)	40-49
				Subtraction mode (Virtual - Colour mix)	50-59
				Inverted Subtraction mode (Virtual - Colour mix)	60-69
				Reserved	70-128
				Virtual colors (virtual has priority)	129
				Crossfade (crossfade between Virtual and Colour mix)	130-254
				Colour channels ("Colour mix" has priority)	255
18	14	20	Zoom	Zoom from max. to min.beam angle (128=default)	0-255
19	*	*	Zoom - fine	Fine zooming (0=default)	0-255
				Shutter closed	0-31
				Shutter open (32=default)	32-63
				Strobe-effect from slow to fast	64-95
				Shutter open	96-127
				Opening pulse in sequences from slow to fast	128-143
				Closing pulse in sequences from fast to slow	144-159
				Shutter open	160-191
				Random strobe-effect from slow to fast	192-223
				Shutter open	224-255
21	16	22	Dimmer	Dimmer intensity from 0% to 100%	0-255
22	*	*	Dimme - fine	Fine dimming	0-255

---

## 9.Maintance and cleaning

**DANGER:Disconnect from the mains before starting any maintenance work.**

It is absolutely essential that the fixture is kept clean and that dust,dirt and smoke fluid residues must not buildup on or within the fixture. Otherwise, the fixtures light-output will be significantly reduced.Regular cleaning will not only ensure the maximum light-output, but will also allow the fixture to function reliably through out its life. A soft lint-free cloth moistened with any good glass cleaning fluid is recommended, under no circum stances should alcohol or solvents be used!

The front objective lens will require weekly cleaning as smoke-fluid tends to building up residues, reducing the light-output very quickly.The cooling-fans should be cleaned monthly.

The gobos may be cleaned with a soft brush,The interior of the fixture should be cleaned at least annually using a vacuum-cleaner or an air-jet.

There are no serviceable parts inside the device except for the lamp and the fuse.

Replacing the fuse: If the lamp burns out,the fine-wire fuse of the device might fuse,too.Only replace the fuse by a fuse of same type and rating.Before replacing the fuse,unplug mains lead.

Maintenance and maintenance of the operation, please contact the manufacturer or distributor.

## 10.Electric equipment specification

### 10.1 Electrical paramters

SOURCE:RGBW LED-60W

POWER:450W

VOLTAGE:AC100-240V 50/60HZ

Color Temperature:6500K

### 10.2 Weight and dimensions

Dimensions : 250X165X336mm

NET WEIGHT:5.8Kg

Dimensions (Carton Package) : 445X360X270mm

WEIGHT (Carton Package) : 7.2Kg

### 10.3 Channel Characteristics

1. 22、16、22 DMX channel .
2. Scan: Pan450° ,Tilt228° ,Fixture could auto reset.
3. Demmer: limear dimmer.
4. Shutter: electronic shutter, random strobe.
5. Zoom:linear amplifier..

## 10.4 Menu Function

1. Touch screen, English menu.
2. DMX values and communication quality values can be displayed in each channel. .
3. Monitor could ON/OFF automatically.
4. Show fixture use time.
5. The DMX signal is disconnected, the amplification is automatically retracted.
6. Wireless input,wired input,wirelss in/xlr out,ethnet input.
7. With DMX software upgrade.

## 10.5 light table

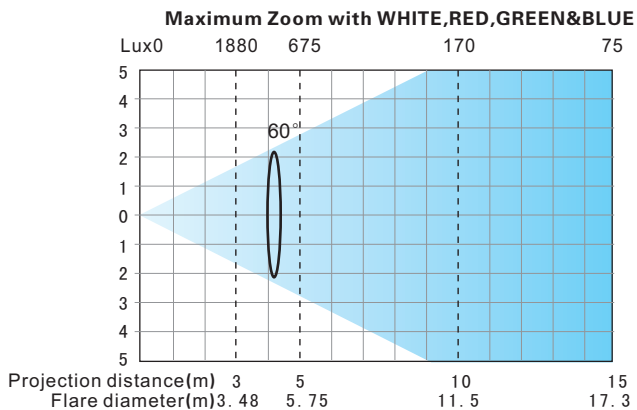
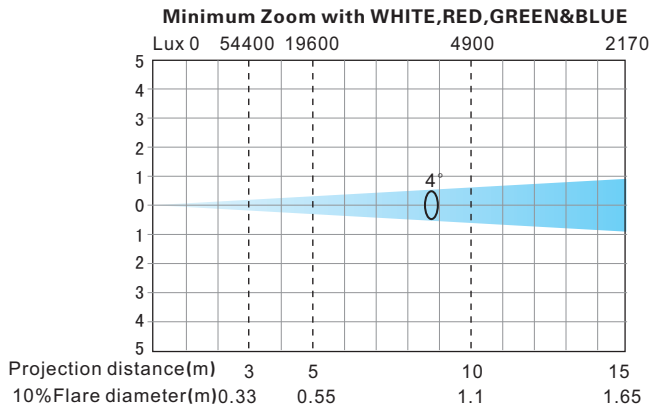

## 11. Electronic drawing

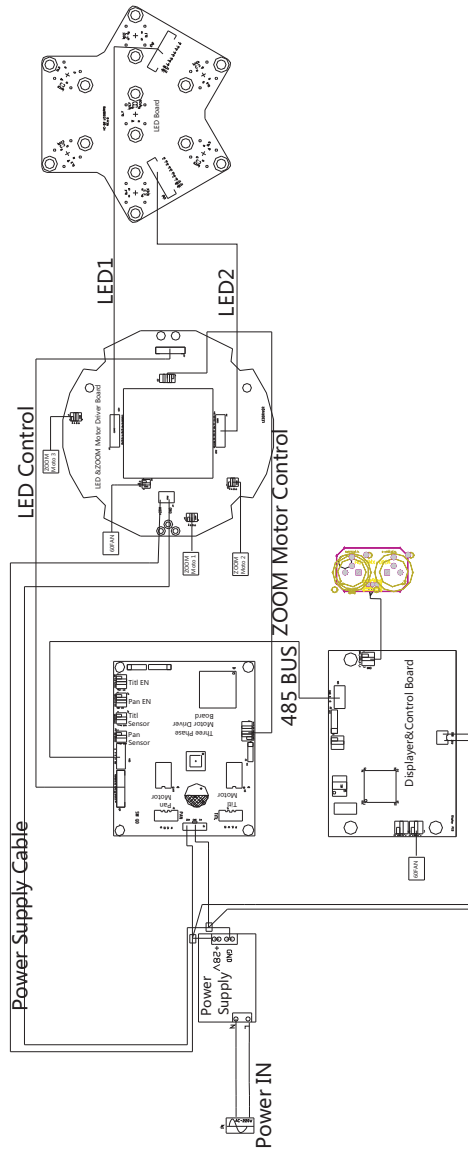

**Note:** The above contents for reference only and is subject to change without prior notice, please take specification you have on hand and our company reserves the final right of interpretation.



